

INSTRUCTIONS (Gender Neutral Language)

BEFORE USING THIS KIT:

- ✓ Read through these instructions.

DO NOT USE THIS KIT:

- ✗ During monthly bleeding (period), wait until bleeding is over.
- ✗ If you are pregnant. See your health care provider about a Pap test.
- ✗ If you are living with HIV or have had a solid organ transplant. See your health care provider once a year for a Pap test.
- ✗ If you've had your cervix removed (e.g. total hysterectomy, gender-affirming surgeries). See your health care provider to see if screening is still recommended.

1) Wash your hands. Get undressed from the waist down.

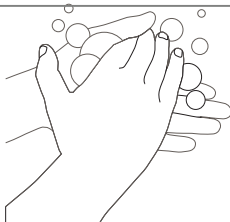

2) **Collect your sample:** hold the red cap to remove the swab from the tube. Put the tube on a clean surface. Do not touch the soft end of the swab.

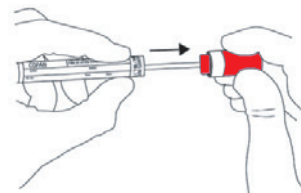

3) Hold the swab at the red line.

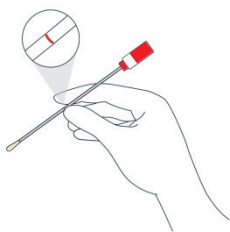

4) Stand or sit with your legs apart. Using your other hand, hold back the folds of skin.

5) Gently insert the swab into the genital opening until your fingers touch your external genitals. Rotate the swab for 20 seconds and remove the swab.

6) Slide the swab into the plastic tube and close firmly.

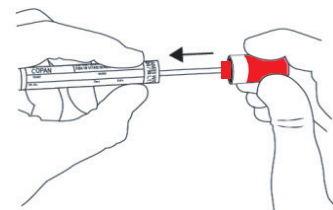

IF COMPLETING KIT AT THE CLINIC:

7) Double check your health care provider has labelled the collection date on your tube. Place the tube into the plastic bag. Seal the bag.

IF COMPLETING KIT AT HOME:

7) **CLEARLY** write your collection date on the tube label **AND** the lab requisition. Place the tube into the plastic bag. Seal the bag.

TRAN	
Hao	
06 APR 1972	9876 543 214
COLLECTION DATE:	
D D M M M Y Y Y Y	
(e.g. 01 JAN 2021)	

8) Return the sealed bag containing your tube to your health care provider.

8) Put the sealed bag and your lab requisition into the prepaid return envelope.

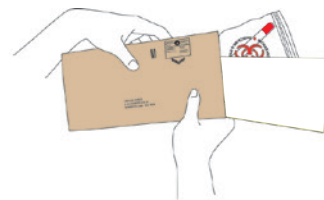

9) Your health care provider will complete your lab requisition and submit your sample to the lab for you.

9) Drop off the envelope today at a Canada Post office or post box.



OR

Frequently Asked Questions

Will I collect my sample correctly? Will it hurt?

Cervix self-screening is easy and should not hurt. Only a small sample is needed. By following these instructions, you will be able to easily and safely collect your own sample.

What if I have trouble collecting my own sample?

You can take your kit to your health care provider to have them help explain how you can take your own sample or your health care provider can use this kit to take the sample for you.

How long will it take to get my results and how do I access my results?

You and your health care provider will get results between four to six weeks after you have mailed in your sample. Your lab results will also be available through **MyCareCompass** (formerly **my ehealth** and **my results**) if you have signed up for this service at: www.bc.mycarecompass.lifelabs.com.

What if a high-risk HPV type is found?

Learning that you have a high-risk HPV type does not mean you have or will develop cancer. Your results however will help you and your health care provider figure out next steps. Depending on your results, you may need a Pap test or colposcopy.

What happens if I can't return my kit the same day I collect my sample?

It is recommended that you wait to complete your kit on a day you are available to drop off your sample at a Canada Post office or post box right after. However, if that is not possible, please make sure to drop off your sample no more than 7 days after your sample collection date.

I lost/damaged my kit; can I request a new one?

If you lost or damaged your kit, please call BC Cancer Cervix Screening to request a new one at: 1-877-702-6566.

Should I store my sample at a specific temperature?

No, it is fine to store your sample at room temperature. Please remember to drop off your sample at a Canada Post office or post box no more than 7 days after your sample collection date.

Will this kit test for anything other than HPV?

This kit only tests for high-risk types of HPV. If you would like to test for other sexually transmitted infections (STIs), please speak with your health care provider.

Experiencing cervical cancer symptoms?

If you experience genital bleeding after sex, bleeding between cycles (if not on testosterone) or after menopause; break through bleeding on testosterone; abnormal or increased production of genital fluid; unexplained pelvic pain or pain during sex; talk to your health care provider. It is important to investigate these symptoms - even if your screening results are normal.

Contact BC Cancer Cervix Screening if you have questions:

1-877-702-6566

www.screeningbc.ca/cervix-pilot

Except as authorized by BC Cancer, any reproduction, modification or distribution of these instructions, in whole or in part, is strictly prohibited. Version: February 2023



TRANS CARE BC
Provincial Health
Services Authority

**BC
CANCER** CERVIX
SCREENING
Provincial Health Services Authority